

Beverley Drive, Prestatyn, Denbighshire LL19 7PU

£145,000

🛏 2 🚿 1 🛋 1



An opportunity has arisen to purchase a well maintained two bedroom semi-detached bungalow in a sought after residential area close to the town of Prestatyn. The property benefits by way of off road parking, uPVC double glazing and gas central heating. Shops catering for most everyday needs are a short distance away as well as the beach and promenade. DIRECTIONS - From the Prestatyn Office turn left onto Meliden Road and at the mini roundabout turn right onto Ffordd Pendyffryn and immediate left onto Fforddisa, proceed to the crossroads and turn right onto Ffordd Penrhwyfla, turn right onto Seabank Drive and first right onto Beverley Drive, follow the road round and the property will be found on the right hand side by way of a 'For Sale' sign.

Key Features

- Semi detached bungalow
- Two bedrooms
- Gardens front and rear
- Ample off road parking
- No FORWARD CHAIN
- Close to bus routes
- Close to amenities
- Council Tax Band -
- EPC -
- FREEHOLD

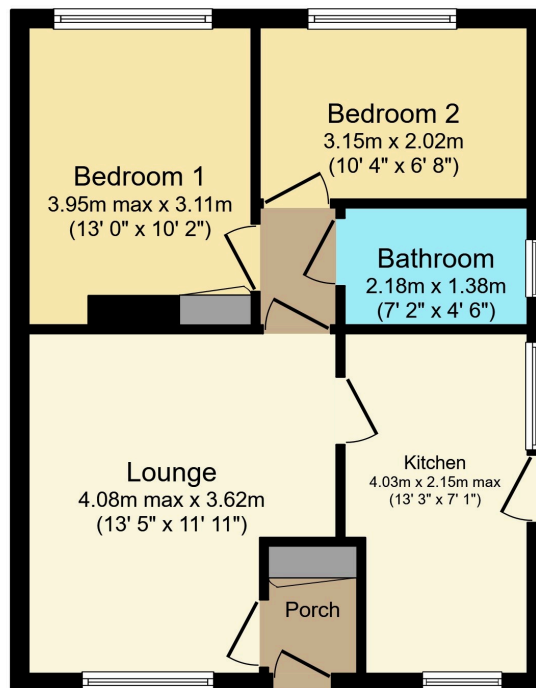

Floor Plan

Floor area 44.6 sq.m. (480 sq.ft.) approx

Total floor area 44.6 sq.m. (480 sq.ft.) approx

This plan is for illustration purposes only and may not be representative of the property. Plan not to scale.

Powered by audioagent.com

CONSUMER PROTECTION REGULATIONS 2008 AND THE BUSINESS PROTECTION FROM MISLEADING MARKETING REGULATIONS 2008

These particulars, whilst believed to be accurate, are set out to for guidance only and do not constitute any part of an offer or contract. Prospective purchasers or tenants should not rely on these particulars as statement or representation of fact, but must satisfy themselves by inspection or otherwise as to their accuracy. No person in the employment of PETER LARGE Estate Agents has the authority to make or give any representation or warranty in relation to the property. Room sizes are approximate and all comments are of the opinion of PETER LARGE Estate agents having carried out a walk through inspection. These sales particulars are prepared under the consumer regulations 2008 and are governed by the business from misleading marketing regulations 2008.